



200mW 635nm Single Mode Diode Laser

Absolute Maximum Ratings

Item	Symbol	Absolut max. Ratings	Unit
Forward Current (Tc=25°C)	If	300	mA
Allowable Reverse Current (Tc=25°C)	Ir (LD)	85	mA
Storage Temperature	Tstg	-40 ~ +100	°C
Operating Case Temperature	Tc	-5 ~ +65	°C

Optical Characteristics

Item	Condition	Symbol	Min	Typ	Max	Unit
Optical Output Power	If=260mA	Po	-	200	-	mW
Dominant Wavelength	If=260mA	λ_d	632	635	638	nm
Threshold Current	CW	Ith	55	80	105	mA
Slope Efficiency	CW	η	0.5	0.95	1.2	W/A
Operating Voltage	If=260mA	Vop	3.7	-	4.9	V
Beam Divergence (raw diode beam)	If=260mA	$\Delta\theta_{//}$	5	9	13	deg.
		$\Delta\theta_{\perp}$	13	18	23	deg.
Beam Size (4 σ)	If=260mA	-	-	4x1	-	mm

Wires

Red = Plus

Black = Minus



LDM-635-200

200mW 635nm Single Mode Diode Laser

Dimensions

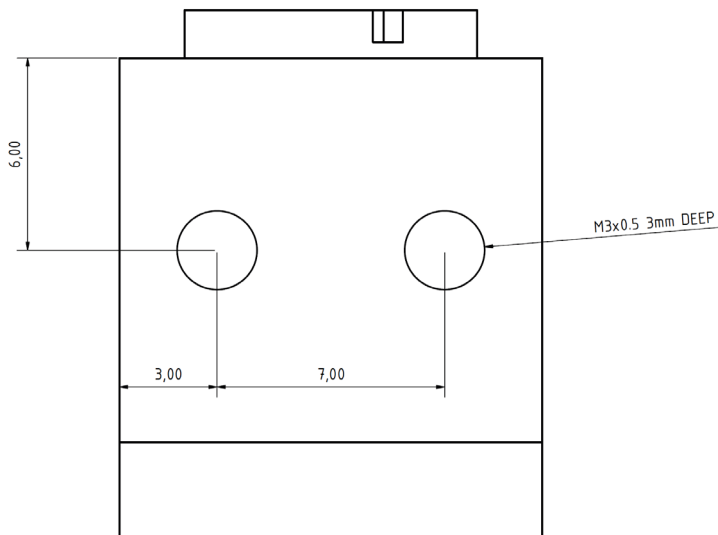
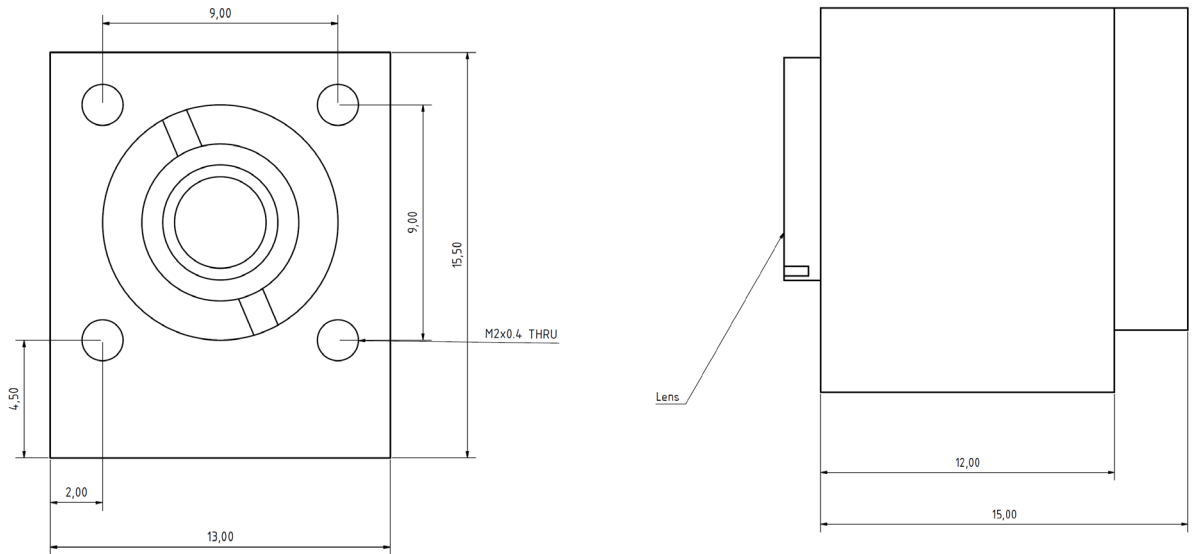

Connecting wires:

Red: PLUS
Black: MINUS

Lasertack GmbH

Fon: +49 56170562870

Fax: +49 56170562871

Email: info@lasertack.com

Web: www.lasertack.com