

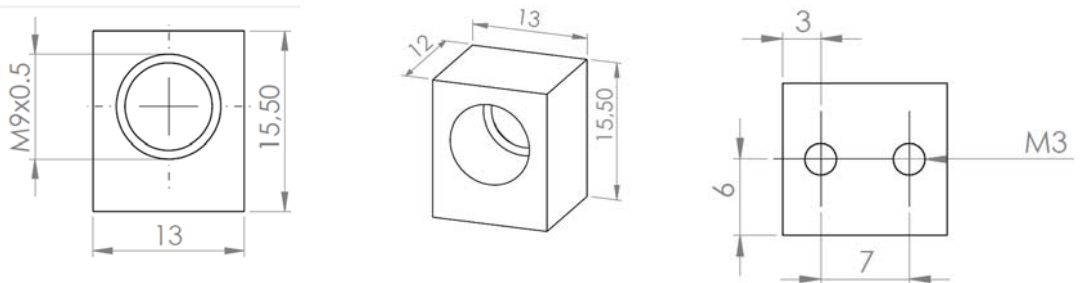

**Datasheet**  
**LDM-635-200**  
**200mW 635nm Laser**

**Features**

- High Power
- Small Size
- Long MTF



**Absolute Maximum Ratings**

Item	Symbol	Absolut max. Ratings	Unit
Forward Current	If	300	mA
Allowable Reverse Voltage	Ir (LD)	85	mV
Storage Temperature	Tstg	-40 ~ +100	°C
Operating Case Temperature	Tc	-5 ~ +60	°C

**Optical Characteristics**

Item	Condition	Symbol	Min	Typ	Max	Unit
Optical Output Power (25°C)	If=260mA	Po	-	200	-	mW
Dominant Wavelength (25°C)	If=260mA	$\lambda_d$	632	635	638	nm
Threshold Current (25°C)	CW	Ith	55	80	105	mA
Slope Efficiency	CW	$\eta$	0.5	0.95	1.2	mW/A
Operating Voltage	If=260mA	Vop	2.3	2.7	3.0	V
Beam Divergence (raw LD data)	If=260mA	$\theta_{//}$	5	9	13	deg.
		$\theta_{\perp}$	13	18	23	deg.

**Wires:      Black = Minus**  
**Red = Plus**

All technical parameters are subject to change without notice.



New Laser Generation

Fon: +49 561 70562870

Fax: +49 561 70562871

Mail: info@lasertack.com

Web: www.lasertack.com